

ARMAÇÃO VIGA

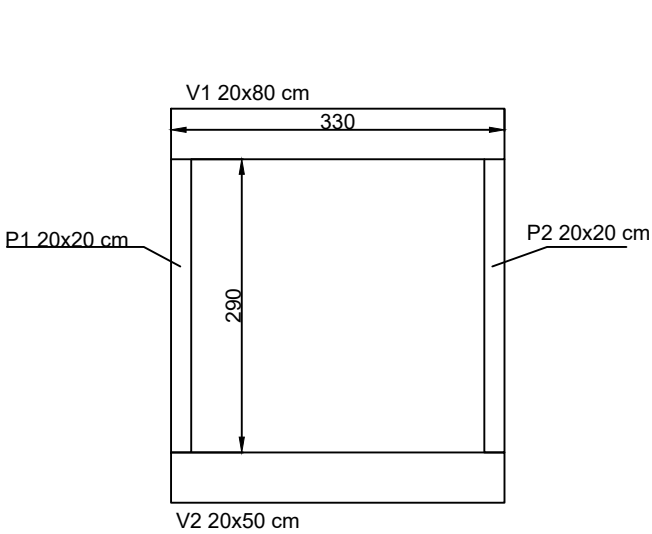

V1 20x80 cm (2x)
17 N10 Ø 8.0 mm C= 186 cm
c/20

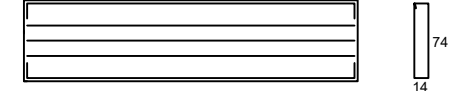

2 N7 Ø 12.5 mm C= 354 cm

15 324 15
6 N8 Ø 8.0 mm C= 354 cm

15 324 15

15 324 15

4 N9 Ø 10.0 mm C= 354 cm

15 324 15

4 N9 Ø 10.0 mm C= 354 cm

V2 20x50 cm (2x)
17 N14 Ø 8.0 mm C= 120 cm
c/20

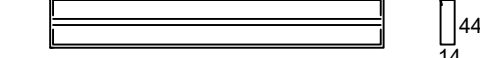

4 N11 Ø 10.0 mm C= 354 cm

15 324 15

4 N12 Ø 6.3 mm C= 354 cm

15 324 15

15 324 15

2 N13 Ø 10.0 mm C= 354 cm

2 N13 Ø 10.0 mm C= 354 cm

ARMAÇÃO ALAS 4X

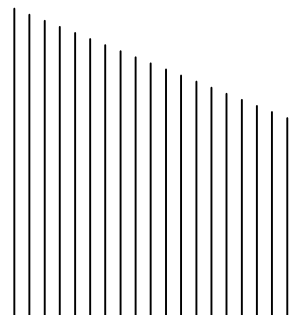
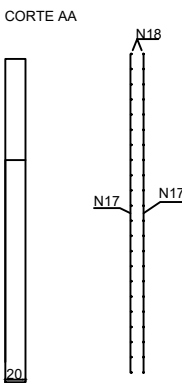
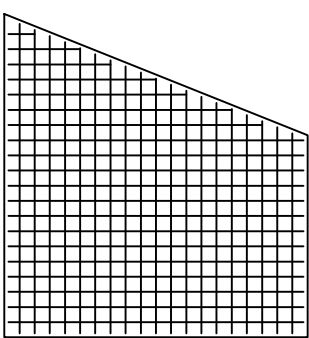
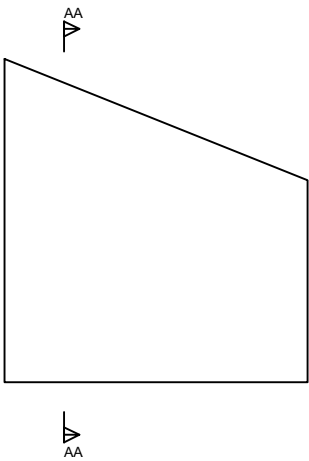

40 N17 Ø 8.0 mm C= VARIADO (242~342)
c/15

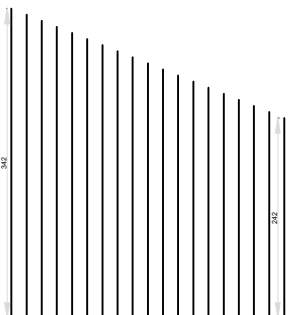

40 N17 Ø 8.0 mm C= VARIADO (242~342)
c/15

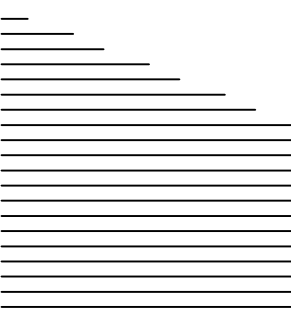

46 N18 Ø 8.0 mm C= VARIADO (26~292)
c/15

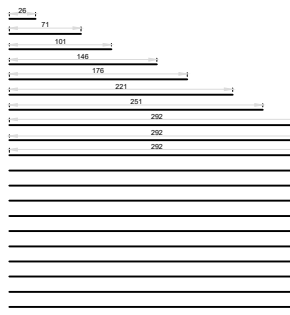

46 N18 Ø 8.0 mm C= VARIADO (26~292)
c/15

ARMAÇÃO PILAR
20x20 cm (4x)

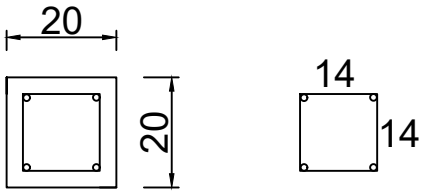

18 N15 Ø 6.3 mm C= 60 cm c/20
04 N16 Ø 12.5 mm C= 400 cm

LIGAÇÃO ALA COM PILAR (4X)

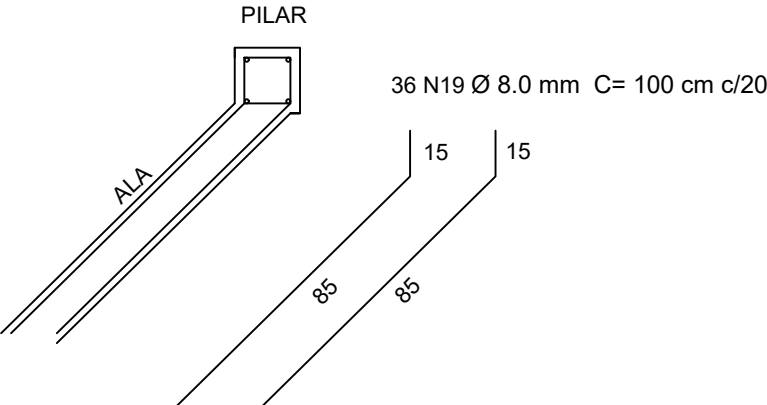

DETALHE VIGA/PILAR

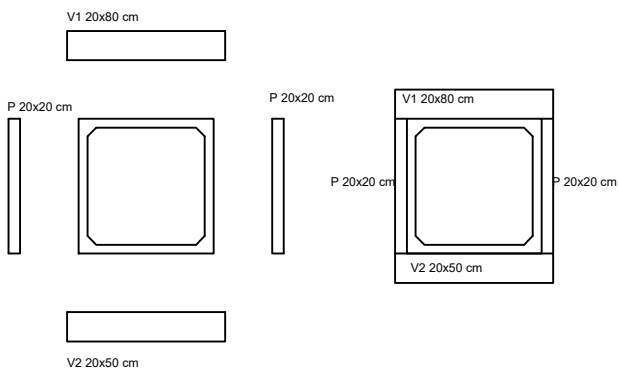

PREFEITURA DE CHAPADA DOS GUIMARÃES		
SECRETARIA MUNICIPAL DE INFRAESTRUTURA		
ASSUNTO: BUEIRO SIMPLES CELULAR DE CONCRETO 250X250 cm		
OBRA: SUBSTITUIÇÃO DE PONTE POR ADUELAS		
LOCAL: CÓRREGO VIRA SAIA		
AUTOR DO PROJETO: _____		
ENG. DAYNA APARECIDA DA SILVA - CREA - MT 49.331		
COORDENADAS: 15° 6'43.69"S 55°44'43.24"W	DATA: AGOSTO/2021	
DIMENSÕES: 250X250X700 cm	VISTO:	FOLHA:
DESCRIÇÃO: ARMAÇÃO ALA/VIGA/PILAR		04/04